

CONCEPT MODELS

Web Address: <http://www.con-sys.com>
Email: concept_models@con-sys.com

8331 Sheep Ranch Rd.
Mountain Ranch, CA 95246

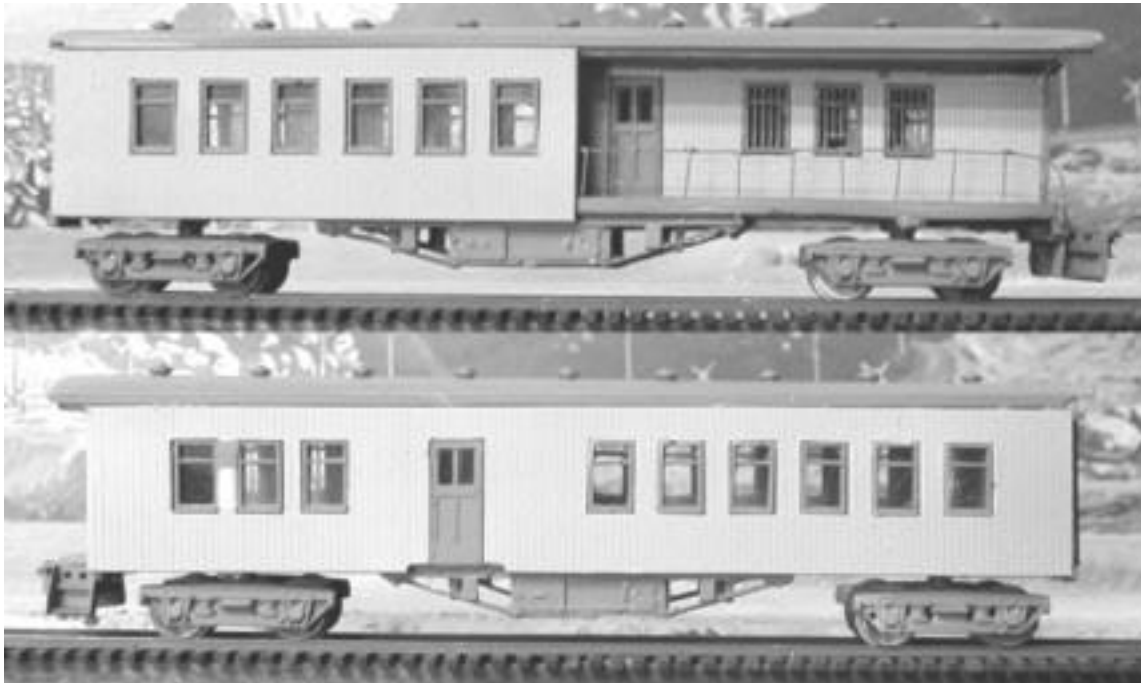

**INSTRUCTIONS FOR
OLD TIME PAYCAR**

PARTS

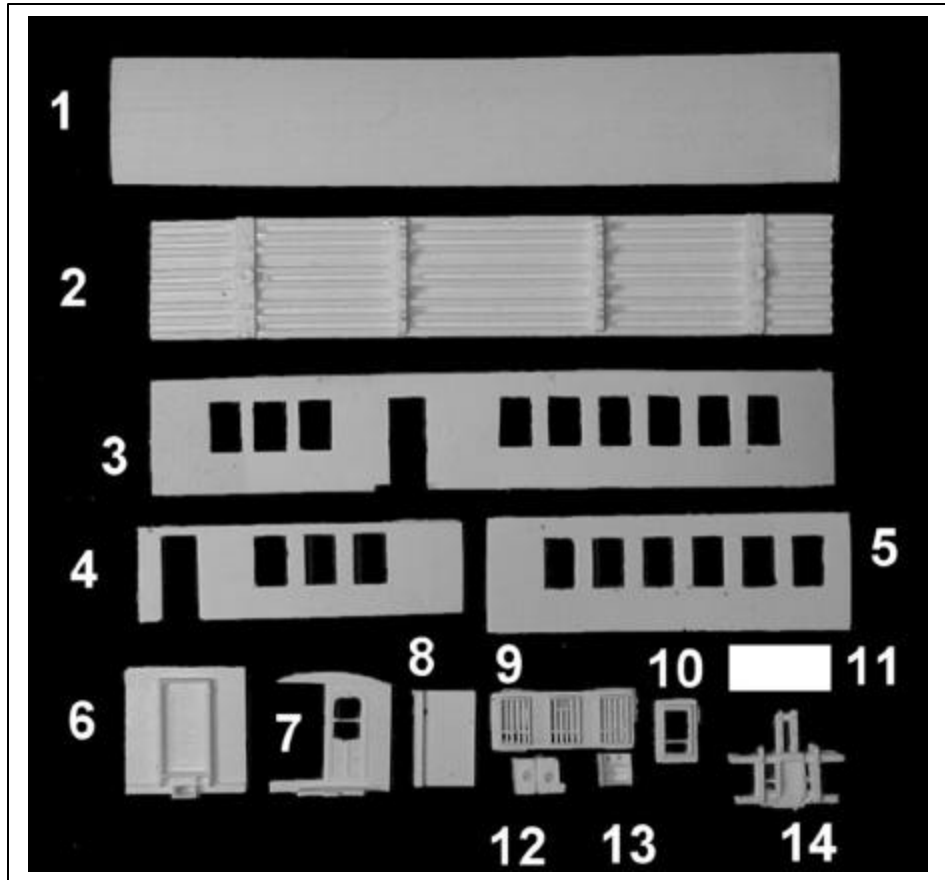

Item No.	PART NO.	DESCRIPTION	QTY
1	4003-1	Roof	1
2	4003-2	Floor/Underframe	1
3	4003-3	Long Side	1
4	4003-4	Pay Window Side	1
5	4003-5	Sort Side	1
6	4003-6	Rear End	1
7	4003-7	Front End	1
8	4003-8	Offset Wall	1
9	4003-9	Pay Windows (set of 3)	1
10	4003-10	Window	15
11	B-327	Door	2
12	4003-12	Wire Bending Jig	1
13	B-42	Steps	2
14	B-	End Platform	1
15	B-52	Tool Box/Truss Rod Side	2
16	4003-16	Tool Box Core ¼' sq. Sty.	2
17	4003-17	Vents	9

GENERIC PARTS	QTY.
1/8" Pan Hd. Screws	2
'K' Brake Cylinder	1
Brake Staff (Pin)	1
Brake Wheel	1
Coupler Pocket Base	1
Coupler Pocket Covers	2
Handrail Drill Fixture	1
Instructions	1

Tools

All basic model workers tools – files, motor-tool with fine burrs, hobby knife, Wood blocks for holding parts square, metal square, etc.

Drills: 1/8", #76, #72, #68, #50 (2-56 tap drill), #65

Music Wire .020" for handrails. Athearn stanchions for tank cars.

Pins (dressmaker type) for attaching brake wheels and other items.

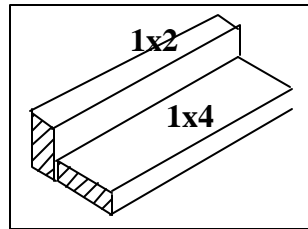

This fixture is a great aid to assembly. It helps hold parts square while gluing and aids in drawing horizontal lines on tanks for tank cars.

Instructions

NOTE: This kit consists of resin castings and must be assembled with an ACC cement (not provided) – both the thicker types as well as the thin. Solvent cements will **NOT** bond the parts together! They can dissolve them. Resin parts are more fragile than common styrene plastic used in injection molded models. Use reasonable care in handling and do not apply any solvents. The illustrations at the front show the general layout of parts for the car. Work very carefully when positioning the parts for gluing. ACC cements adhere very quickly and permanently.

Gluing with ACC Cements – USE WITH CARE

ACC cements allow the modeler to work very quickly. A general rule is to use the thin cements to glue long joints taking advantage of capillary action that makes the cement run the length of the seam. The thicker cement is suited to applying large area parts to each other. An accelerator can be applied sparingly. One technique is to apply the glue to one part and the accelerator to the other part to be joined. I also use a Q-tip to apply a minute amount of accelerator to the glue after the parts have been joined. The accelerator triggers the ACC cement to set very quickly. It is only slightly slower with the thicker cement.

PREPARATION Wash the parts **before** assembling with a dish washing detergent such as “Dawn”. Rub lightly with a soft sponge. Failure to do this may cause paint adhesion problems.

WARNING

Some parts may have lead encapsulated within them. In the event the lead is exposed for any reason, do not allow it to remain on the skin. Dispose of any lead shavings that may result. Obey all safety precautions of all suggested cements and assembly materials.

ASSEMBLY

1 Use the drilling jig to drill the floor for the handrail. If you are holding the floor as shown in the picture, the jig is positioned and clamped over what would be the upper left hand corner. Use a #76 drill.



2 Clean any flash from the Pay Window Set (9) and glue to the pay window side as shown. All windows and doors attach by poking through the side from behind.



3 Install the Steps (13) to the End Platform (14) as shown. The steps are cemented so that the top edge is flush with the floor of the End Platform.

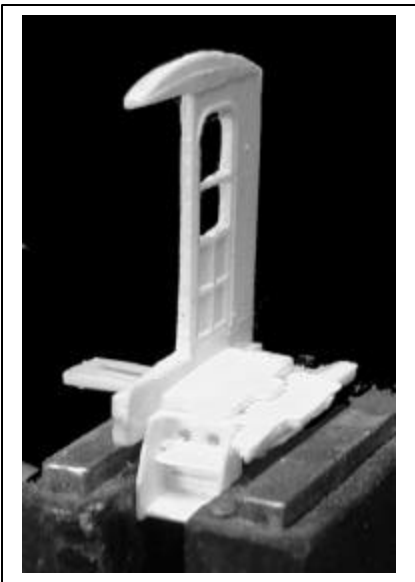
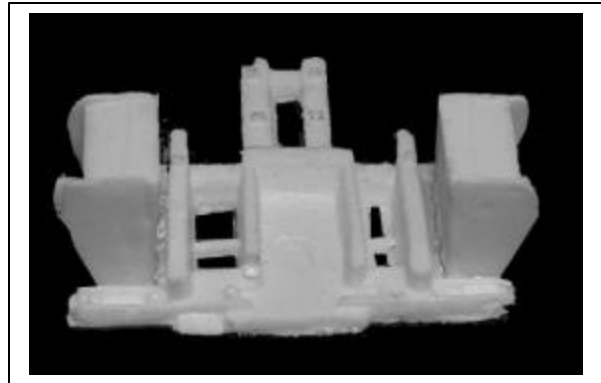

4 Cement the Front End (7) to the end platform assembly.

5 Attach the front end assembly to the end of the floor where the truck bolster is closest to the end.

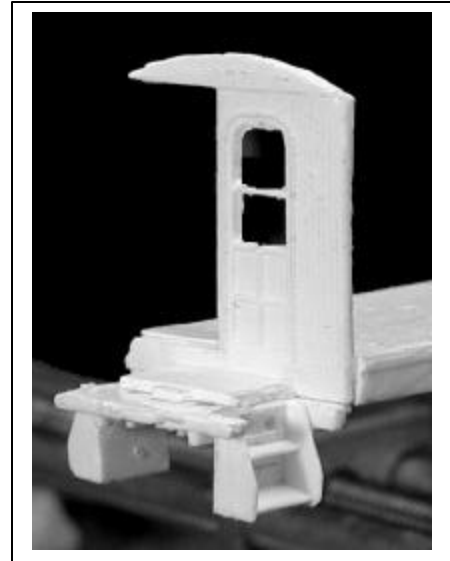

6 Cement the Offset Wall (8) to the pay window assembly as shown and install with the right end at the front end assembly and the wall even with the floor as shown.



7 Cement the windows into the sides as shown. The windows are installed closest to the top edge of the sides with the small pane at the top. Apply cement sparingly only to the edge of the window for best results.

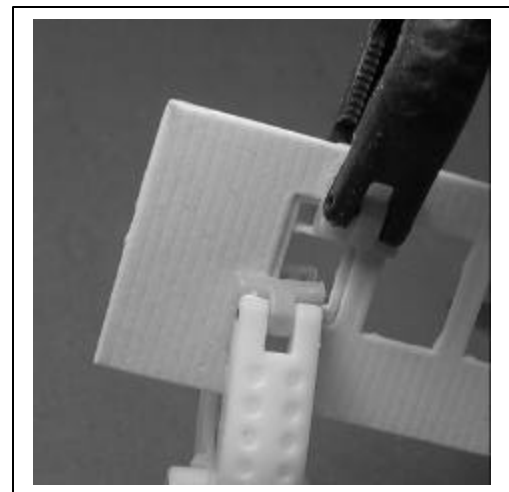

8 Apply the Rear End (6) to the floor and check the fit of the short side assembly.

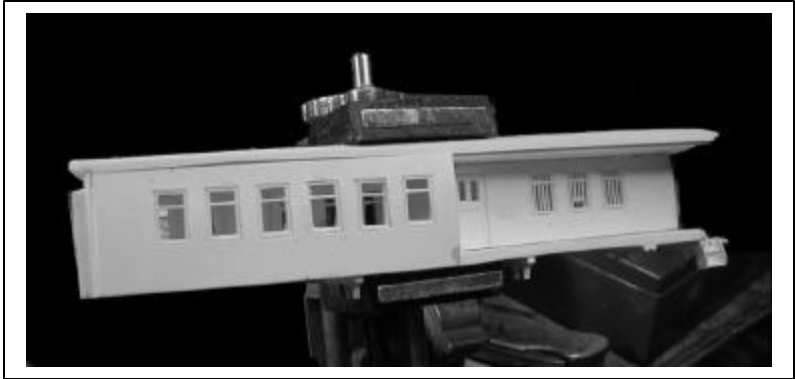

9 Apply the Short Side (5) to the floor adjacent to the pay window assembly.



10 Apply clamping pressure to the car until the cement has set.

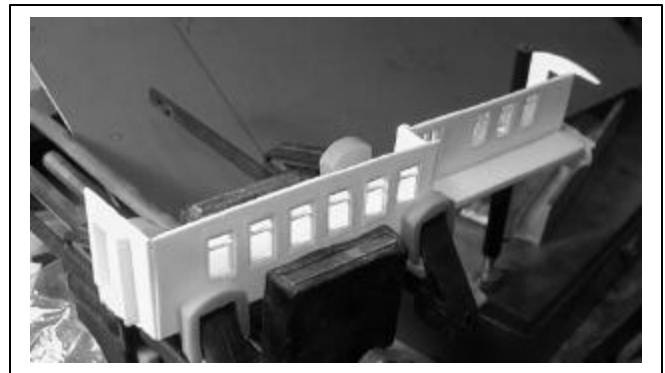

11 Apply a truss rod/ tool box assembly to each side as shown.



PAINING

- 1) If you followed the instructions for cleaning the parts before assembly, you are ready to paint. A primer such as Floquil's is recommended. Allow to dry overnight before proceeding with any of the color coats. When painting with white do not over dilute with thinner. Twenty five percent thinner should be sufficient and will improve coverage. Dark colors can be diluted up to 50-50. Two coats of white with plenty of drying time in between are recommended. White on top of primer is recommended for light colors yellow through red. It improved the color.
- 2) Overcoat entire car with Testor's Glosscoat prior to decaling. If you decal over the Glosscoat as soon as it is dry to the touch, decal adhesion is improved.

DECALING

- 1) Cut out the decal segment you are going to apply.
- 2) Dip the decal in warm water which has had 1 drop of DAWN kitchen detergent. Do **NOT** leave the decal to soak in the water and slide off the backing..
- 3) Slide the decal directly off of the backing onto the wetted surface with a small brush or tweezers. Position with the brush. Remove excess water with a tissue.
- 4) A decal setting solution is recommended for best adhesion.
- 5) Top coat the decals with Testor's Dullcote for best results.